

Slip On Plate Flanges - Tube ID
Class 150 spaced, 316 SS
Inches / Pounds

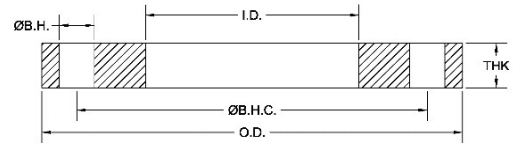

Part #	Tube Size	Inside Diameter (I.D.)	Outside Diameter (O.D.)	Bolt Hole Center Diameter (B.H.C.)	Bolt Hole Diameter (B.H.)	Flange Thickness (THK)	Number of Bolt Holes	Est Weight
KL2TSS	2	2.063	6.0	4.75	0.75	0.5	4	3.2
KL2.5TSS	2.5	2.563	7.0	5.50	0.75	0.5	4	4.5
KL3TSS	3	3.063	7.5	6.00	0.75	0.5	4	4.8
KL4TSS	4	4.06	9.0	7.50	0.75	0.5	8	6.5
KL6TSS	6	6.063	11.0	9.50	0.88	0.5	8	8.2
KL8TSS	8	8.06	13.5	11.75	0.88	0.5	8	11.8
KL10TSS	10	10.063	16.0	14.25	1	0.5	12	15

* Constructed of ASTM A240 316 stainless plate steel or cast in conformance with ASTM A351

* Spacing per ASME B16.5 Class 150, **except for thickness**